



EXPERTS
IN STEEL TANKS



RURAL RAINWATER HARVESTING AND STORAGE SOLUTIONS

Tel: 1300 TANK 4U
1300 8265 48
kingspanwater.com.au



80 YEARS OF EXPERTISE

Kingspan Water- the new name for Tankworks

Since 1934, Tankworks Australia Pty Limited has designed and built long lasting steel water tanks and accessories of exceptional quality. And now, as Kingspan Water, we continue on as the Australian market leaders in water storage and rainwater harvesting.

As the established experts, with three factories across the east coast of Australia, our in-depth knowledge and experience using the latest manufacturing processes and the highest quality materials guarantees your Kingspan Water steel tank is precision-engineered to exceed your expectations.

The Steel Tank Experts

Our 80 years of manufacturing and rain harvesting expertise means Kingspan Water offers high-quality steel water tanks and accessories for the Australian rural markets that are built to last. Utilising many advanced design features and materials, our tanks are strong, fully customisable, corrosion resistant and carry the highest structural wind rating in the market.

The Kingspan Water support teams provide knowledge, expertise and focused customer service. Our mission is to offer a precision-engineered water tank supported by a long-term warranty.



AUSTRALIA'S
LEADING
STEEL TANK EXPERTS

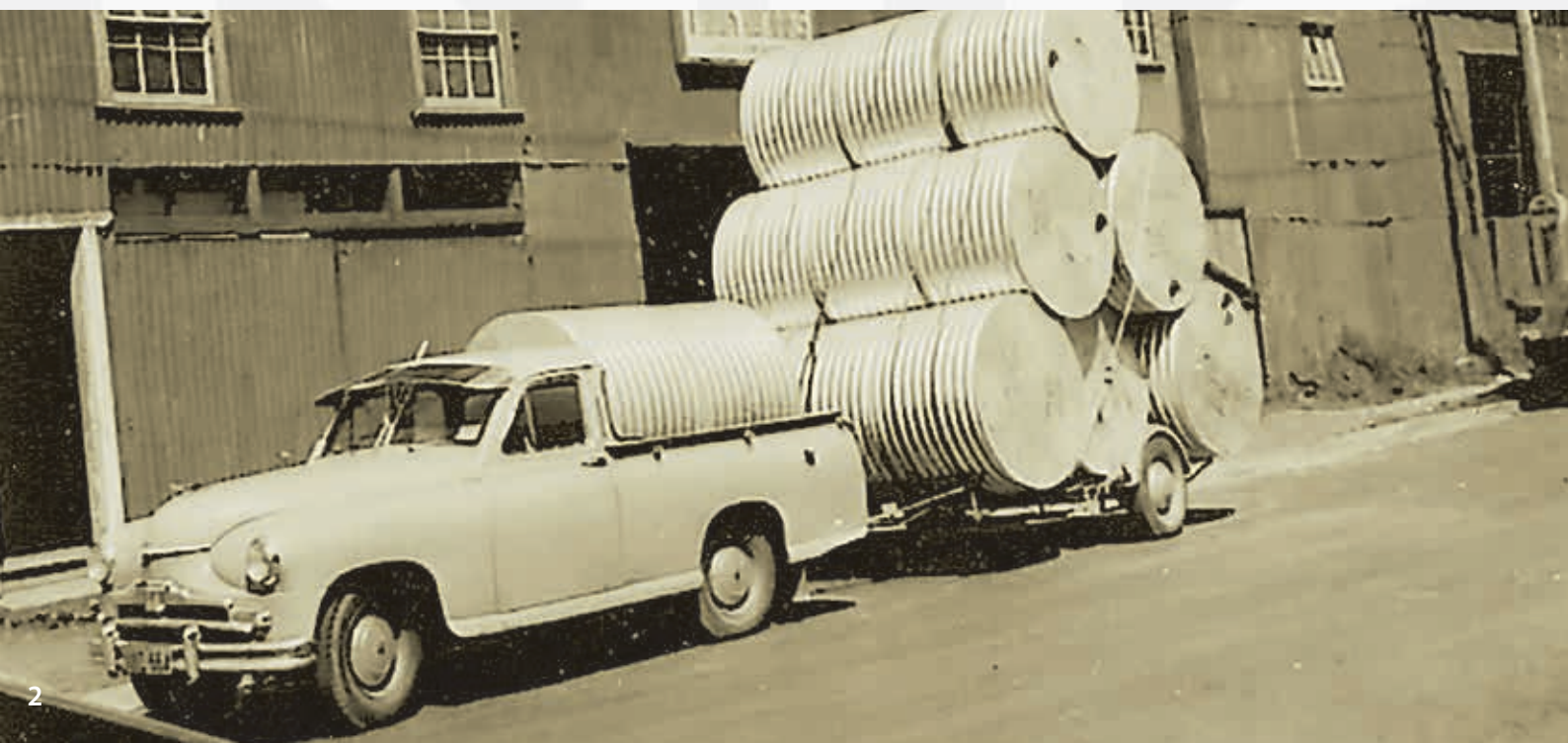



Rural Water Tanks

Kingspan Water Rural Tanks

Our Kingspan Water range of rural tanks benefit from more than 80 years of innovative manufacturing and local rain harvesting and storage experience.

Each tank is available in a wide range of sizes and colours, featuring the true iconic deep corrugated profile with tough Z450 Galvanised steel for a strong and highly corrosion resistant tank with minimal seams. Our tanks are manufactured in Australia and come in two heights with capacities ranging from 24,000 to 542,000 litres, a seven layer heavy duty Polypropylene Liner with scrim technology and are fully customisable with additional outlets, inlets and overflows as required. An easily accessible high-flow filter system, which handles 6x the standard amount of water, won't allow flooding and comes as optional.

All of our tanks are produced and sent to your site as a kit which is then assembled by our local, qualified staff.

EXPERTS IN STEEL

- › With over 80 years' experience delivering high performance and reliable rainwater harvesting solutions throughout Australia, you can trust Kingspan Water.

GALVANISED

- › Tough Z450 Galvanised steel provides a strong, highly corrosion resistant, long lasting and low maintenance water tank solution.

SERVICE

- › We pride ourselves on a quality customer experience- from comprehensive and professional on-site assembly to expert after sales care.





MADE IN
AUSTRALIA
With local knowledge

PROVEN EXPERIENCE

HOUSEHOLD SUPPLY

Kingspan Water offer complete rainwater harvesting and storage solutions for both rural and semi-rural households- including pumps, filters and advice on the right sized tank to suit your needs.



FIRE

We provide fire storage tanks designed and built with the required fittings and accessories to ensure 100% compliance to AS 2419 for residential and commercial applications.



STOCK WATERING

Providing sufficient and quality stock watering solutions for rural property owners and their animals is paramount to our design. We provide an economically large capacity water tank for primary producers designed to handle the harsh Australian conditions



IRRIGATION

Rural properties requiring a tank for irrigation need a reliable storage tank and a pump. Some use an on-demand pump to take the water straight from the ground and into the irrigation system, while others pump water slowly from a bore and store it in a tank for later use. Ideally the tank can be designed to supply the irrigation system via gravity. Whatever your needs, Kingspan Water will design the best irrigation system for you.



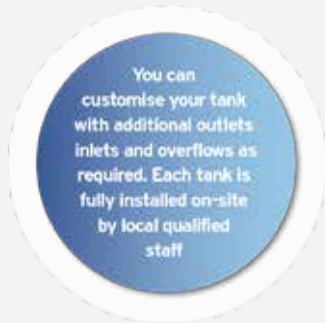

GALVANISED STEEL VS ZINCALUME®

The galvanised steel used in our Kingspan Water tanks has been proven, time and time again, to outperform Zincalume®.

Galvanised steel is highly corrosion resistant and is regularly used in harsh environments constantly in contact with water and moisture- such as large road culverts, pipework and fencing posts.

Because of the robust galvanised construction of our tanks, we do not require sacrificial anodes to maintain your 20-year corrosion warranty when installed as per our Base Preparation Instructions. This means peace of mind for you and no need to replace costly anodes every 5-10 years as is the case with a Zincalume® tank.

Although galvanised steel incurs a larger initial investment, the superior performance ensures a longer life, lower maintenance costs, and a better overall return on your investment.

7 LAYERS OF PROTECTION

Every Kingspan Water steel tank comes with a heavy duty polypropylene liner with scrim technology as standard. It is constructed of a durable seven layer supported by a high strength woven base material and is lightweight, flexible, extremely tough and suitable for use in a wide range of water and effluent containment and storage applications including agricultural, industrial, aquaculture, building and construction.

Features:

- › Polypropylene liner with scrim technology
- › Approved for contact with potable water
- › Environmentally friendly
- › 20 year warranty against UV degradation under the harsh Australian conditions
- › Watertight joints
- › Excellent welding characteristics for faster processing and more secure welds

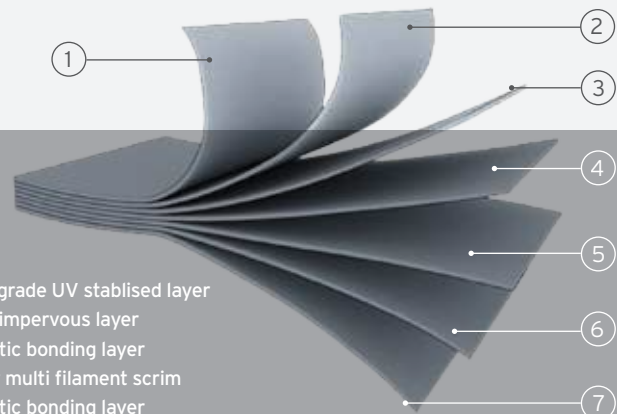

1. Black, food grade UV stabilised layer
2. Waterproof impervious layer
3. Thermoplastic bonding layer
4. 1000 denier multi filament scrim
5. Thermoplastic bonding layer
6. Waterproof impervious layer
7. Black, food grade UV stabilised layer

7 layer heavy duty Polypropylene Liner with scrim technology (standard).

Tough Z450 GALVANISED

steel provides a strong, highly corrosion resistant, long lasting and low maintenance water tank solution

EXPERTS IN STEEL TANKS SINCE 1934

STANDARD FEATURES



7 layer heavy
duty polypropylene
liner with scrim
technology



Galvanised walls
standard for longer
life compared to
Zincalume®



All standard
Colorbond® colours
are available



Vermin and
dust protection



Large lockable
painted Access
Hatch to match
your tank

EXPERTS
IN STEEL TANKS



KINGSPAN WATER
EXPERTS IN STEEL TANKS

OPTIONAL FEATURES

- › Removable access ladder
- › High - Flow filter system
- › Additional outlets as required (25, 32, 50, 65, 75, 100, 150 mm options POA)
- › Rainsaver roof catchment system
- › Large range of pumps and covers



Large capacity
500mm Inlet
Strainer with
Light Guard



All metal Outlet
with brass ball
valve



Large 50mm cross
section hot dipped
Galvanised Roof
Trusses



Internal Smart
Clip System
for bladder
attachment



TANK SPECIFICATION

Our Range

Kingspan Water offers a large range of capacities to suit your intended usage requirements, roof catchment area and available space.

TANK DIMENSIONS

S-MODEL	DIAMETER	HEIGHT	CAPACITY	
LT2 4S	3.8m	2.1m	24,000L	5,200Gal
LT33S	4.5m	2.1m	34,000L	7,500Gal
LT46S	5.3m	2.1m	46,000L	10,200Gal
LT60S	6.1m	2.1m	60,000L	13,300Gal
LT76S	6.8m	2.1m	76,000L	16,800Gal
LT94S	7.6m	2.1m	94,600L	28,800Gal
LT114S	8.3m	2.1m	114,000L	25,200Gal
LT135S	9.1m	2.1m	136,000L	30,000Gal
LT159S	9.8m	2.1m	159,900L	35,200Gal
LT185S	10.6m	2.1m	185,000L	40,800Gal
LT212S	11.4m	2.1m	212,000L	46,900Gal
LT240S	12.1m	2.1m	242,000L	53,300Gal
LT270S	12.9m	2.1m	273,000L	60,200Gal
LT300S	13.6m	2.1m	306,000L	67,500Gal
LT340S	14.4m	2.1m	341,700L	75,000Gal
LT370S	15.1m	2.1m	378,000L	83,400Gal

T-MODEL	DIAMETER	HEIGHT	CAPACITY	
LT33T	3.8m	3.01m	34,000L	7,400Gal
LT48T	4.5m	3.01m	49,000L	10,500Gal
LT66T	5.3m	3.01m	66,000L	14,500Gal
LT86T	6.1m	3.01m	87,000L	18,900Gal
LT109T	6.8m	3.01m	110,000L	24,000Gal
LT135T	7.6m	3.01m	135,600L	29,800Gal
LT164T	8.3m	3.01m	164,000L	36,000Gal
LT195T	9.1m	3.01m	195,000L	42,900Gal
LT229T	9.8m	3.01m	229,000L	50,400Gal
LT265T	10.6m	3.01m	266,000L	58,300Gal
LT305T	11.4m	3.01m	305,000L	67,000Gal
LT347T	12.1m	3.01m	347,000L	76,300Gal
LT392T	12.9m	3.01m	392,000L	86,200Gal
LT439T	13.6m	3.01m	440,000L	96,500Gal
LT489T	14.4m	3.01m	490,000L	107,500Gal
LT542T	15.1m	3.01m	542,000L	119,200Gal

*All table dimensions are approximate.



COLOUR SPECIFICATION

Blend your tank into the background
or match the current colour scheme
of your property.

Colours to suit any environment

Along with the standard galvanised appearance, Kingspan Water offer the full range of Colorbond® colours .

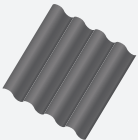
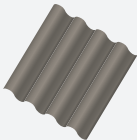
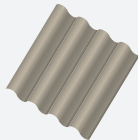
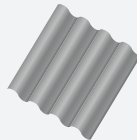
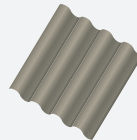
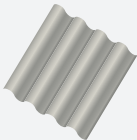
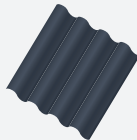
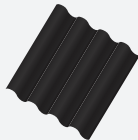
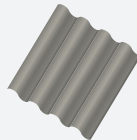
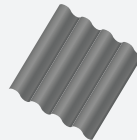
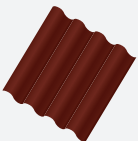
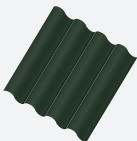
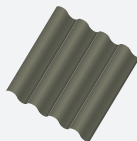
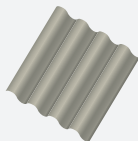
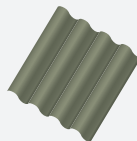
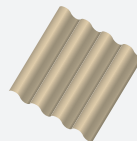
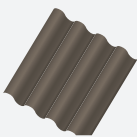
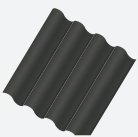
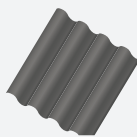
BASALT™**GULLY™****IRONSTONE®****PAPERBARK®****SHALEGREY™****COVE™****TERRAIN®****SURFMIST®****DEEP OCEAN®****MONUMENT®****DUNE®****WIND SPRAY®****MANOR®****COTTAGE GREEN®****MANGROVE™****HAZE®****PALE EUCALYPT®****CLASSIC CREAM™****WOODLAND GREY™ JASPER®****WALLABY™****NIGHT SKY®**



CUSTOMER SERVICE

SERVICE

We stand by the quality and performance of Kingspan Water products and our support doesn't stop once your tank is installed. We're on standby with guidance on servicing and maintenance. Our trained professional support team is only a phone call away.



Peace of mind with our 20 year pro-rata warranty

Peace of mind with our extended warranty
We offer a 20-year pro-rata construction and anti-corrosion warranty on your galvanised steel water tank.



Customer support when you need it

Our friendly local customer service team are on hand with professional advice. We operate a dedicated helpline on 1300 TANK 4U and a support email address for customers on ruralwater.au@kingspan.com



Service and maintenance

We recommend that you service your Water Tank once a year to ensure smooth running of your whole system.



Rural Water Tanks

Experts in Steel Tanks Since 1934

OUR FACILITIES

With three manufacturing sites on Australia's east coast (Sydney, Brisbane & Melbourne), Kingspan Water is dedicated to providing long lasting steel water storage and rainwater harvesting tanks. We've built our reputation on quality.

OUR PEOPLE

We employ only the brightest and most experienced people who understand rural living.

Our expert team of engineers and local qualified professionals deliver the best in water storage and rainwater harvesting storage solutions to your property.

We are industry leading manufacturers, and it's our people who make the difference.



Sydney

8 Bessemer Street
Blacktown, NSW 2148

Melbourne

860 Cooper Street
Somerton, VIC 3062

Brisbane

93 Magnesium Drive
Crestmead, QLD 4132

ruralwater.au@kingspan.com
kingspanwater.com.au



Distributor:

Tel: **1300 TANK 4U**
1300 8265 48
kingspanwater.com.au